



SOUNDINGS			
Sounding No.	Ground Elev.	Driven to Elev.	Remarks
1	98.64	98.98	Through a mixture of sand and gravel.
2	98.54	91.00	Through sandy clay to refusal.
3	97.0	91.00	" " " " " "
4	96.7	92.00	Red penetrated 1/2" per blow for 4.6' to refusal.
5	96.7	92.00	" " " " " "

Hole No.	Ground Elev.	Remarks on Borings
6 979 916		To 3' clay & gravel, very dry & compact.
7 984 924		To 8' gray sandy clay, less compact.
8 991 928		To 8' sandy filler hard pan, very compact.
9 992 943		To 12' very firm hard pan, 3' to 4' stones.
10 995 915		To 12' sandy clay very compact.
11 995 913		To 12' same as above but more moisture.
12 995 942		Same as hole no. 10. At 6' struck boulder or possibly ledge.

Curve Data, Cons. Line

$\Delta = 50^{\circ}06'30''$   
 $D = 6$   
 $T = 446.60'$   
 $L = 835.10'$

Equation  
 Final Sta 421+80.05 equals  
 Original Sta 422+22.87  
 $E = -42.82'$

Final Sta 421+80.05 equals  
 Original Sta 422+22.87  
 $E = -42.82'$

800' VC Ex = 120

STATE HIGHWAY COMMISSION  
 BRIDGE DIVISION  
**RAILROAD CROSSING**  
 OVER THE TRACKS OF THE  
 CANADIAN PACIFIC RAILWAY  
 IN THE TOWNSHIP OF  
 SAPLING  
 SOMERSET COUNTY  
 SURVEY PLAN  
 Sheet 3 of 20 Sheets  
 Sept. 1935  
 AUGUSTA, MAINE

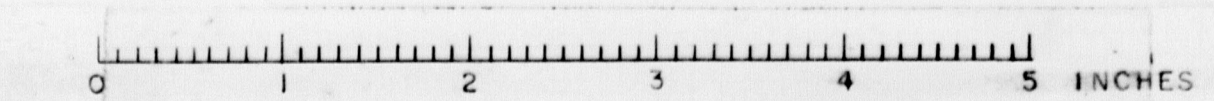



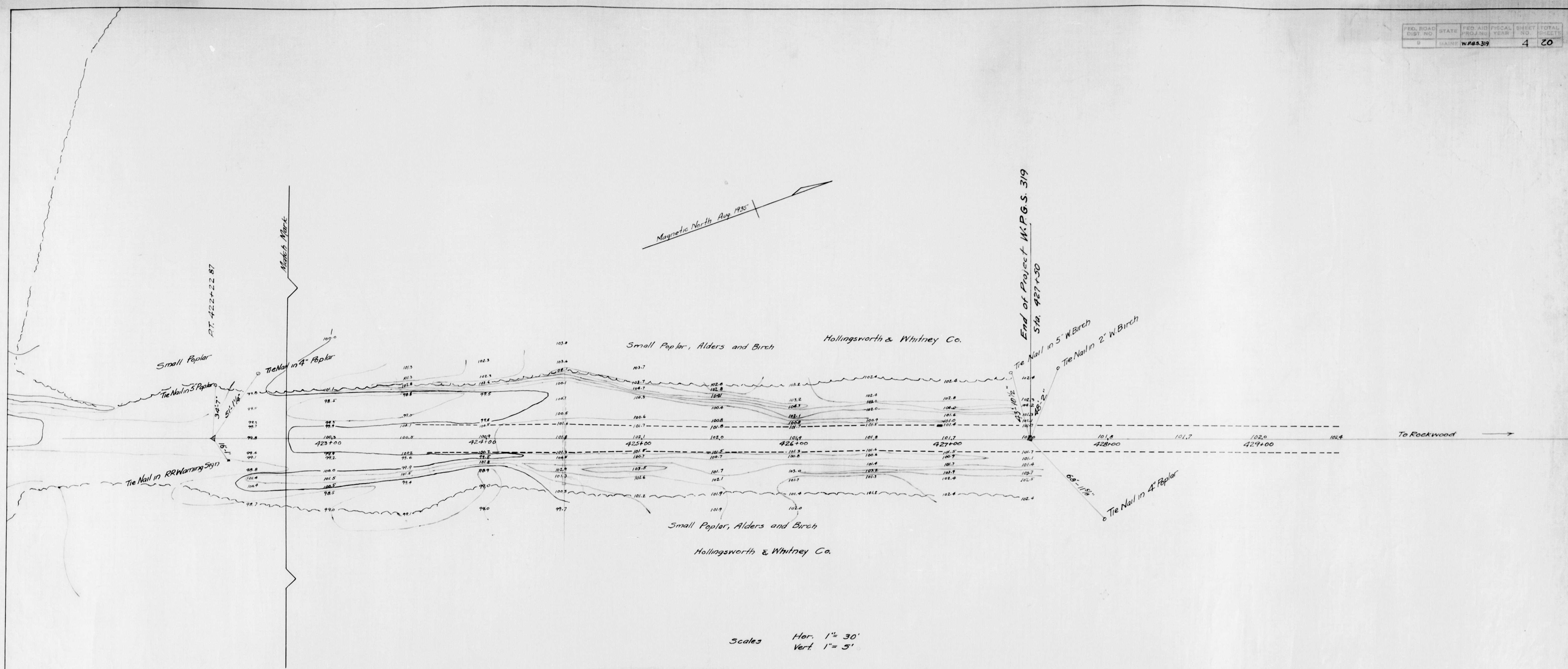

Scales Hor. 1" = 30'  
Vert. 1" = 5'

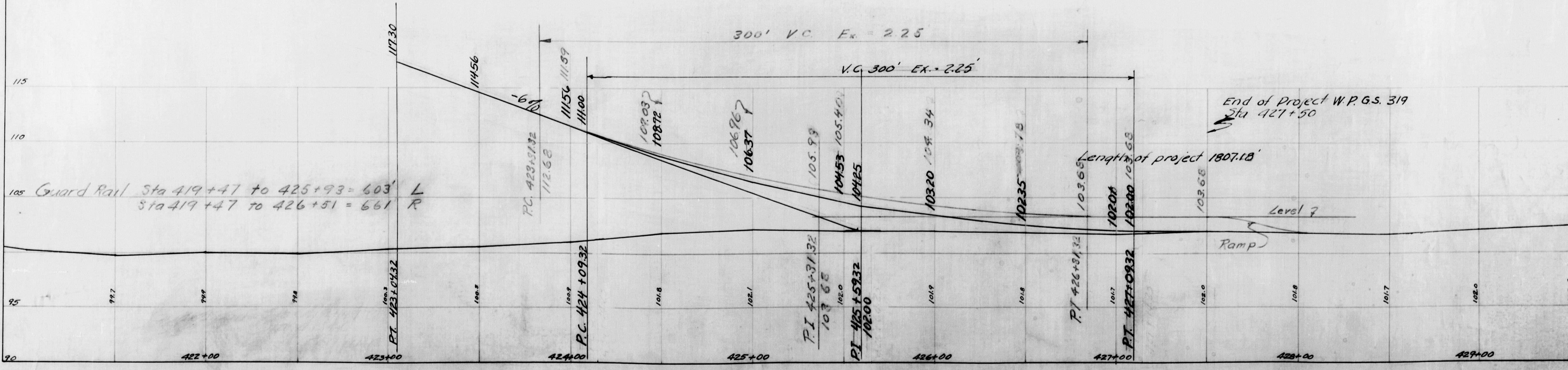

Survey by A.D. MacDonald  
Plotted by S.S. Mitchell  
Traced by S.S. Mitchell

TOWN 13-51  
BRIDGE 3256

STATE HIGHWAY COMMISSION  
BRIDGE DIVISION  
RAILROAD CROSSING  
OVER THE TRACKS OF THE  
CANADIAN PACIFIC RAILWAY  
IN THE TOWNSHIP OF  
SAPLING  
SOMERSET COUNTY  
SURVEY PLAN  
Sheet 4 of 20 Sheets Sept. 1935  
AUGUSTA, MAINE.

